



锂霸电池  
Lithium Batteries

# 物联时代

IoT Era



## 3V 锂锰纽扣电池助力美好生活

3V Lithium Batteries Power Your Life

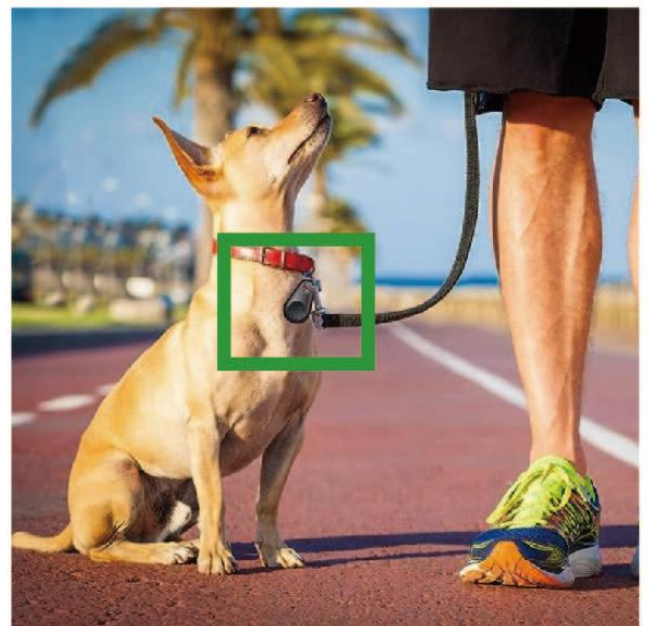

## 绿色环保3V锂锰电池

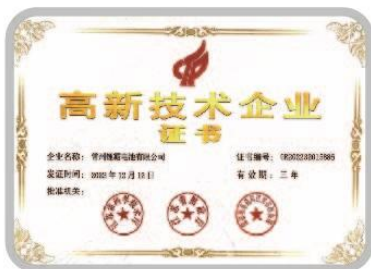

### 技术研发 Research & Development

独特的能源配比和密封结构提高了电池容量；既能小电流长时间供电，又能满足大电流的脉冲放电。锂霸电池也获得了“长寿命电池”的美誉。High battery capacity owing to unique chemical recipe and sealed structure, catering low drain long duration and high drain pulse discharge, Liba CR battery being well-known for long shelf life and service life.



### 智能化&数字化生产 Automated and digitized manufacturing

全程数字化监控，触摸屏控制工艺参数，智能化缺陷识别，360度超声波清洗。Digital monitoring and control on all critical parameters throughout the process, quality assurance by AOI (automatic optical inspection), and final cleaning by holistic ultra sonic washing facilities.



### 安全&质量管控 Safety & quality control

从来料到出货，全程数据管控，持续改善，贯彻6西格玛理念，成品出厂前100%电性测试及防漏、安全、寿命方面的抽检测试。做到安全第一，质量可靠。From incoming material to finished goods, quality control by 6-sigma concept; 100% test on OCV, CCV, and SCC; Ongoing testing on leakage-proof, safety and service life, in order to achieve sustainable quality and reliability.

先进的生产&测试&检验设备  
Advanced Manufacturing, Testing, Inspection Machines and Equipments





锂霸电池  
Lithium Batteries

### 3V锂锰原电池 3V Primary Lithium Batteries

型号 Model	放电电阻 Load(K $\Omega$ )	容量 (mAh) Capacity	初始最小平均 放电时间 (h) MAD (Initial)	标准放电电流Is (mA) Standard working Current	最大连续电流 Imax (mA) Max Continous Working Current	最大脉冲电 流Ip (mA) Max Pulse Working Current	最大异 常充电 电压 (V)	最大异常充 电电流 (mA) Abnormal Charge Current Limit	标称尺寸 (mm) Nominal Dimension	标称重量 (g) Weight
CR920	68	25	565	0.1	0.3	5	3	1	$\Phi$ 9.5*2.0	0.55
CR927	62	32	660	0.1	0.3	5	3	1	$\Phi$ 9.5*2.7	0.65
CR1025	68	30	680	0.1	0.3	5	3	1	$\Phi$ 10.0*2.5	0.70
CR1212	68	20	450	0.1	0.3	5	3	1	$\Phi$ 12.5*1.2	0.60
CR1216	62	25	520	0.1	0.3	5	3	1	$\Phi$ 12.5*1.6	0.75
CR1220	62	38	780	0.1	0.5	5	3	1	$\Phi$ 12.5*2.0	0.80
CR1225	62	50	1035	0.1	0.5	5	3	1	$\Phi$ 12.5*2.5	0.85
CR1616	30	50	500	0.1	1.0	8	3	3	$\Phi$ 16.0*1.6	1.10
CR1620	30	75	760	0.1	1.0	8	3	4	$\Phi$ 16.0*2.0	1.25
CR1632	15	130	680	0.2	1.0	8	3	5	$\Phi$ 16.0*3.2	2.00
CR2016	30	100	1000	0.1	1.0	15	3	4	$\Phi$ 20.0*1.6	2.00
CR2020	30	120	1200	0.1	1.0	15	3	4	$\Phi$ 20.0*2.0	2.20
CR2025	15	180	900	0.2	1.0	15	3	6	$\Phi$ 20.0*2.5	2.60
CR2032	15	240	1200	0.2	1.0	15	3	8.5	$\Phi$ 20.0*3.2	3.20
CR2050	15	240	1200	0.2	1.0	15	3	8.5	$\Phi$ 20.0*3.2	3.20
CR2320	15	130	650	0.2	2.0	20	3	6	$\Phi$ 23.0*2.0	3.00
CR2325	15	190	950	0.2	2.0	20	3	8	$\Phi$ 23.0*2.5	3.30
CR2330	15	260	1300	0.2	2.0	20	3	10	$\Phi$ 23.0*3.0	4.00
CR2335	15	300	1500	0.2	2.0	20	3	10	$\Phi$ 23.0*3.5	4.30
CR2354	7.5	550	1375	0.4	2.0	20	3	10	$\Phi$ 23.0*5.4	6.90
CR2412	15	100	500	0.2	2.0	25	3	5	$\Phi$ 24.5*1.2	2.20
CR2430	15	300	1575	0.2	3.0	25	3	10	$\Phi$ 24.5*3.0	4.20
CR2440	7.5	480	1200	0.4	3.0	25	3	10	$\Phi$ 24.5*4.0	5.40
CR2450	7.5	600	1500	0.4	3.0	30	3	10	$\Phi$ 24.5*5.0	6.00
CR2477	5.1	1000	1700	0.59	3.0	30	3	14	$\Phi$ 24.5*7.7	10.50
CR3032	7.5	550	1375	0.4	3.0	35	3	10	$\Phi$ 30.0*3.2	6.80
CR3832	3.75	850	1062	0.8	20.0	75	3	20	$\Phi$ 38.0*3.2	11.00

备注 Remarks:  
容量的测试方法和条件见规格书 Capacity shown according to product specification testing conditions.

#### 环保Environmental Friendly

- 符合Compliance with
- Battery Regulation (EU) 2023/1542
  - RoHS Directive 2011/65/EU
  - ISO14001
  - REACH EC1907/2006

#### 安全Safety

- 符合Compliance with
- UL1642
  - IEC60086-4
  - UN38.3

**LiBA CR2450 & CR2032 见证全球电子价签发展**

LiBA CR2450 & CR2032 Witness of Global ESL Development

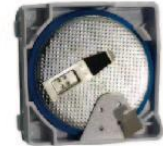
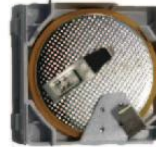

**3V 锂锰纽扣电池应用**  
3V Lithium Button Cell Application

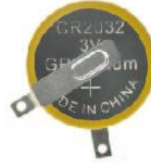

**电脑主板, 遥控器, 计步器**  
Computer memory back-up, Remote Controls, Pedometers

**体温计, 电子秤, 血糖仪**  
Thermometers, Electronic scales, Glucose meters



计步器

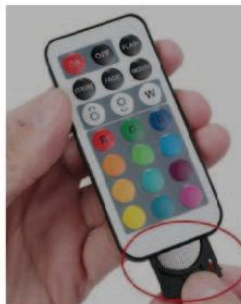

**定制化引脚-电池组-线束**  
**Customization Flexibility-Variou Pack & Assembly**

**CR2032 with two tags**

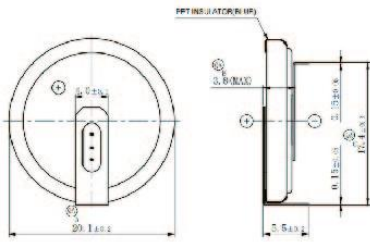

**CR2032 with three tags**

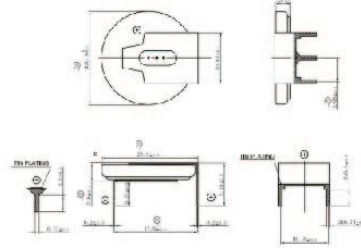

**CR2450 with two tags**

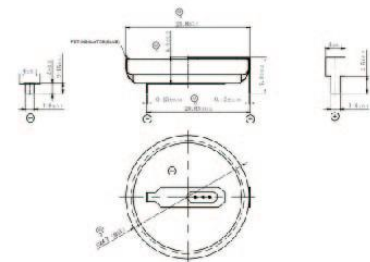

**CR2450 with three tags**

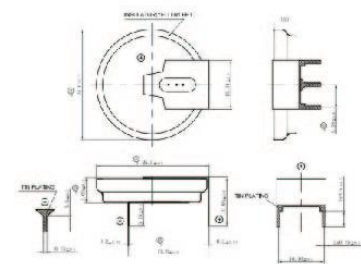

**CR2032 battery pack**

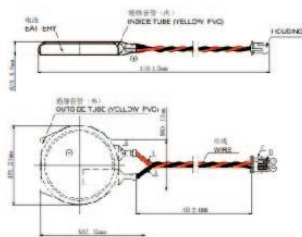

**CR2032 battery pack**

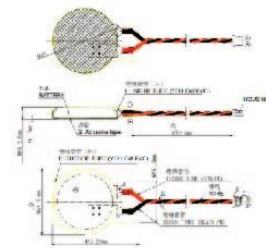

**CR2450 battery pack**

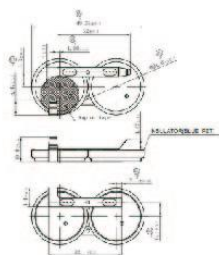

**CR2450 battery pack**

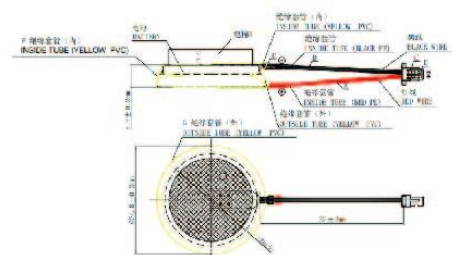

### 3V 锂锰纽扣电池生产流程

#### 3V Lithium Coin Production Process

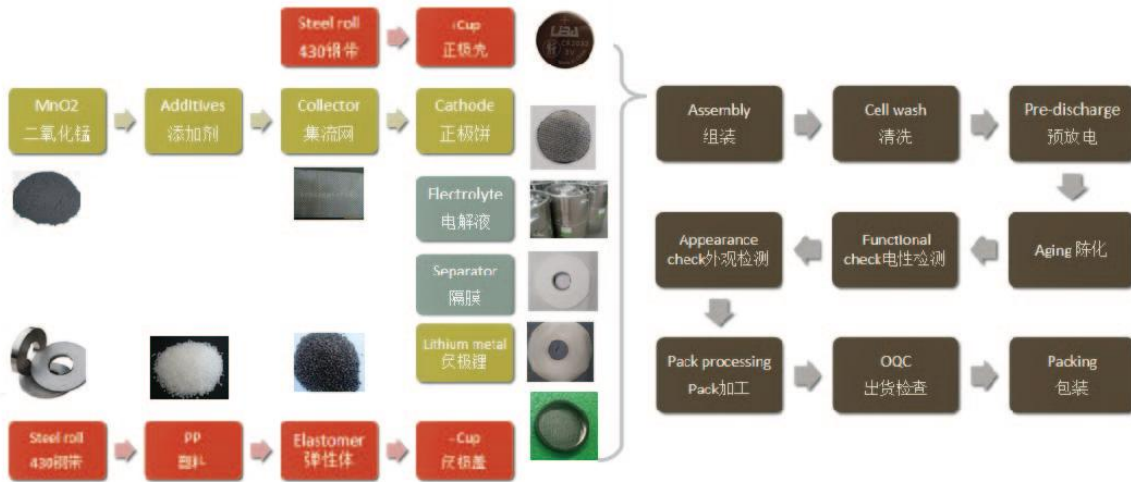

### 3V 锂锰纽扣电池部件构成图

#### 3V Lithium Coin Component Diagram

1. 注塑负极盖Anode cap with seal ring
2. 负极锂Anode lithium metal
3. 隔膜Separator
4. 正极饼Cathode EMD
5. 正极壳Cathode cap



### 外形尺寸

#### Overall Dimension

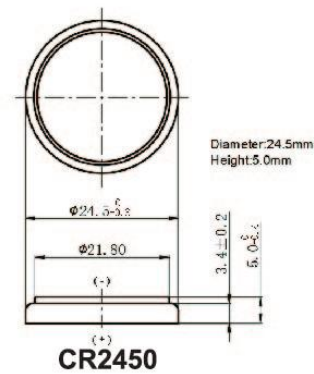
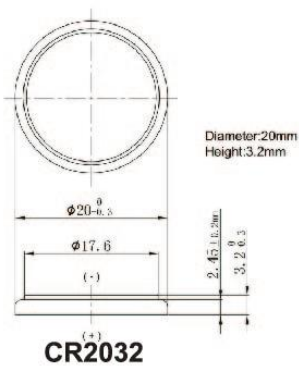

**3V 锂锰柱状电池**  
**3V Lithium Cylindrical Battery**





**智能安防, 智能水表, 无线传感器, 数码相机, 智能门磁, 智能水阀**  
Smoke detector, Water meter, Wireless sensor, Camera, Door security, Automatic water Tap



**注意事项**

**Dos and Don'ts**

 <b>警告</b>	
<p>请放置在小朋友接触不到的地方；吞咽会导致化学灼伤、软组织穿孔和死亡；摄入后2小时内可能发生严重烧伤；一旦发生吞咽，请立即就医。</p>	

 <b>WARNING</b>	
<p><b>KEEP OUT OF REACH OF CHILDREN</b> Swallowing can lead to chemical burns, perforation of soft tissue, and death. Severe burns can occur within 2 hours of ingestion. Seek medical attention immediately.</p>	



请勿扔进火中

DO NOT DISPOSE OF IN FIRE



请勿错误安装

DO NOT INSERT INCORRECTLY



请勿损坏或使电池变形

DO NOT DAMAGE OR DEFORM



请勿充电

DO NOT CHARGE



裸手拿捏正负极

Holding positive and negative caps with bare hand



拿捏电池边缘

Holding the rim of battery with bare hand



**B的正极接通了，A的正负极**

Cathode, anode of A and cathode of B in close loop

**导致A短路**

A being short circuited



A的负极和C的负极接通，A的正极和B的正极接通，B的正极和C的负极接通

Cathode, anode of A, cathode of B and anode of C in close loop,

**导致A短路 (B, C. 正常)**

A being short circuited

## 专利&证书 Patent & Certification



**Monitoring result for Changzhou Lithium Batteries Ltd. on site Site 1**

**Monitoring**

Monitoring site	Changzhou Lithium Batteries Ltd.
Module ID	0001-00000001
Site	Site 1
Item tested	Visual inspection
Address	No. 12, Taifu Street, Huihe Town, Jiangyin City, Jiangsu Province, China
City	Jiangsu Province
Country	China

**Overall rating**

Overall Rating	A
----------------	---

**Section rating**

Visual inspection	A
-------------------	---

**UL Product IQ**  
 BBCV2.M H62933 - LITHIUM BATTERIES - COMPONENT  
 Lithium Batteries - Component  
 See General Information for Details - China process  
 CHANGZHOU LITHIUM BATTERIES CO., LTD.  
 常州锂电有限公司  
 Changzhou, Jiangsu 213000 China  
 Test 1: 100% Pass  
 Test 2: 100% Pass  
 Test 3: 100% Pass  
 Test 4: 100% Pass  
 Test 5: 100% Pass  
 Test 6: 100% Pass  
 Test 7: 100% Pass  
 Test 8: 100% Pass  
 Test 9: 100% Pass  
 Test 10: 100% Pass

**检测报告**  
 Test Report  
 报告编号: 2021090101  
 检测日期: 2021年9月1日  
 检测机构: 常州锂电有限公司  
 检测项目: 锂电池组件

**TEST REPORT**  
 Product: Lithium Manganese Dioxide Battery  
 Model and/or Type: DRS400  
 Range: 3.7V (NOMINAL)  
 Test Classifications: Commission test  
 Issue Date: 2021-05-26  
 Tested by: [Signature]  
 Reviewed by: [Signature]  
 Approval by: [Signature]  
 Test Engineer: [Signature]  
 Audit Engineer: [Signature]  
 Approval Engineer: [Signature]  
 Guangzhou MCM Certification & Testing Co., Ltd.  
 广州邦来检测技术有限公司

**LBA**



常州锂霸电池有限公司  
CHANGZHOU LITHIUM BATTERIES LTD.

地址：江苏省常州市新北区赣江路18-1号

Add: No.18-1, Ganjiang Rd (West)  
New-north District, Changzhou, Jiangsu  
PRC. 213000

TEL: 86-519-85100885 MP: 86-18151283318

FAX: 86-519-85111088

E-mail: wendy.zhang@czliba.com

Website : www.czliba.cn/www.czliba.com



小程序



公众号



企业微信